



PAEDIATRIC COT MANUAL FIXED HEIGHT 4H175

USER MANUAL



Table of Contents

| | |
|---------------------------|----|
| INTRODUCTION | 3 |
| SAFETY PRECAUTIONS | 4 |
| GENERAL OPERATION..... | 5 |
| Castors..... | 5 |
| Side & end Rail..... | 6 |
| Trendelenburg..... | 8 |
| SPECIFICATIONS | 10 |
| Basic Dimensions..... | 10 |
| Mattress Size..... | 10 |
| Safe Working Load..... | 10 |
| CLEANING | 11 |
| MAINTENANCE..... | 11 |
| TRANSPORT & STORAGE | 11 |
| ACCESSORIES..... | 12 |
| WARRANTY & SERVICE | 12 |

INTRODUCTION

The Alere 4H175 is a manually operated fixed height paediatric cot.

Ease of use, functionality, safety, soft feel edges and cleaning practicality are some of the key features of the cot.

The cot is fabricated from stainless steel and powder coated steel for a durable frame with light weight CNC machined aluminium side, end rails and plastic covers.

CLINICAL APPLICATION AND AREA OF USE

The cot is appropriate for child patient under supervised medical monitoring.

KEY FEATURES

- Max working load (SWL) 40Kg
- 12° Trendelenburg manual adjustment
- Lightweight CNC machined aluminium side and end rails
- Ventilated CNC machined aluminium mattress base
- Smooth glide side and end rails
- Obstruction free base design for access on all sides and ends
- Hand and knee operated rail latch
- 2 stage safety rail latches
- Soft internal and external edges
- Unique angular safety corners

SAFETY PRECAUTIONS

It is IMPORTANT that this User Manual is read in its entirety prior to operating the cot. The manual is designed to inform users of the how to competently and responsibly operate the product.

It is recommended that the user manual be kept for reference. If required 4Healthcare can provide specialist training.

All warnings and cautions within this manual should be strictly adhered to. Failure to do so could result in harm to the patient or the operator.

GENERAL

- The clinically qualified person responsible should consider the age, size and condition of the patient before using the cot and its accessories.
- Maximum mattress thickness 100mm

- **Do not** use the cot for more than one patient
- **Do not** use accessories that are not designed and/or approved for use with the Alere cot
- **Do not** leave rails down while patient is unattended
- **Do not** lower rails if patient's limbs are protruding through the rails

- **ALWAYS** use a mattress of appropriate size and type
- **ALWAYS** make sure that the patient is safely positioned to avoid entrapment before operating cot
- **ALWAYS** ensure that attendant and patient limbs are free from potential entrapment areas before operating any functions
- **ALWAYS** apply the brakes when the bed is stationary

GENERAL OPERATION

Castors

The Alere cot maybe fitted with single or double wheel locking castors.

- Press the locking tab down to lock the castor
- Release the locking tab to unlock the castor.

! Caution !

- **Always** apply brakes when the bed is in a stationary position.

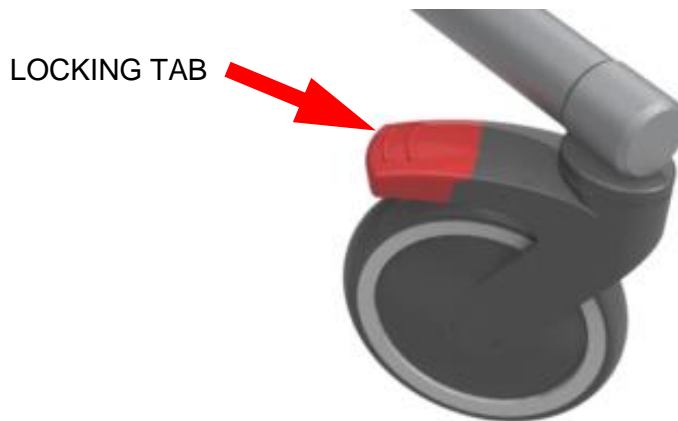

SINGLE WHEEL LOCKING CASTOR

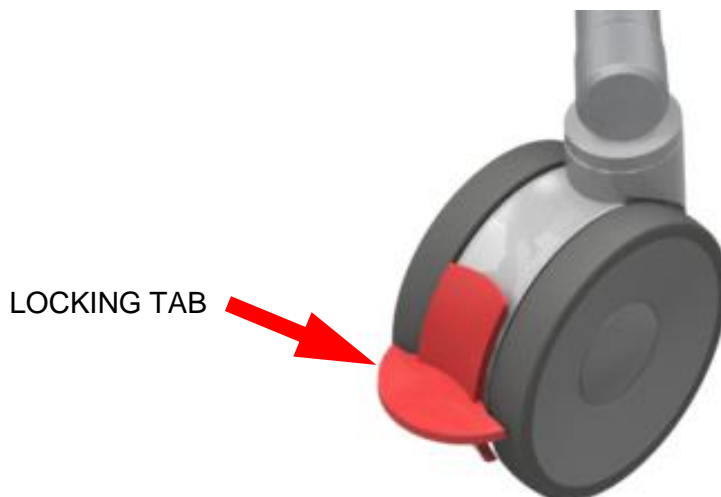

TWIN WHEEL LOCKING CASTOR

Side & end Rail

The rails are positioned either full raised or fully lowered.

WARNING: Do not operate the rails when there is potential of entrapment or crushing to the patient, caregiver, visitor or other equipment.

RAISING THE RAIL:

Raising the rail takes 2 simple steps:

- **LIFT**
- **LOWER**

LIFT the rail by the handle to the very top of the smooth guide rails. This allows the safety latch to return to lock the rail in position.



LOWER the rail onto the latch. The safety latch does not need to be touched in this operation.



LOWERING THE RAIL:

Lowering the rail takes 3 simple steps:

- **LIFT**
- **PRESS**
- **LOWER**

LIFT the rail by the handle to the very top of the smooth guide rails. This allows the safety latch to be pressed with one hand.



PRESS and hold the safety latch.



LOWER the rail past the latch, once the rail is past the latch remove hand from the latch and continue lowering the rail until it rests at the bottom.



Trendelenburg

To operate the Trendelenburg takes 2 simple steps:

- **LIFT**
- **WIND**

LIFT the handle into position. (ensure end rail is in the raised position)



Handle in position

WIND to raise or lower the Trendelenburg angle.

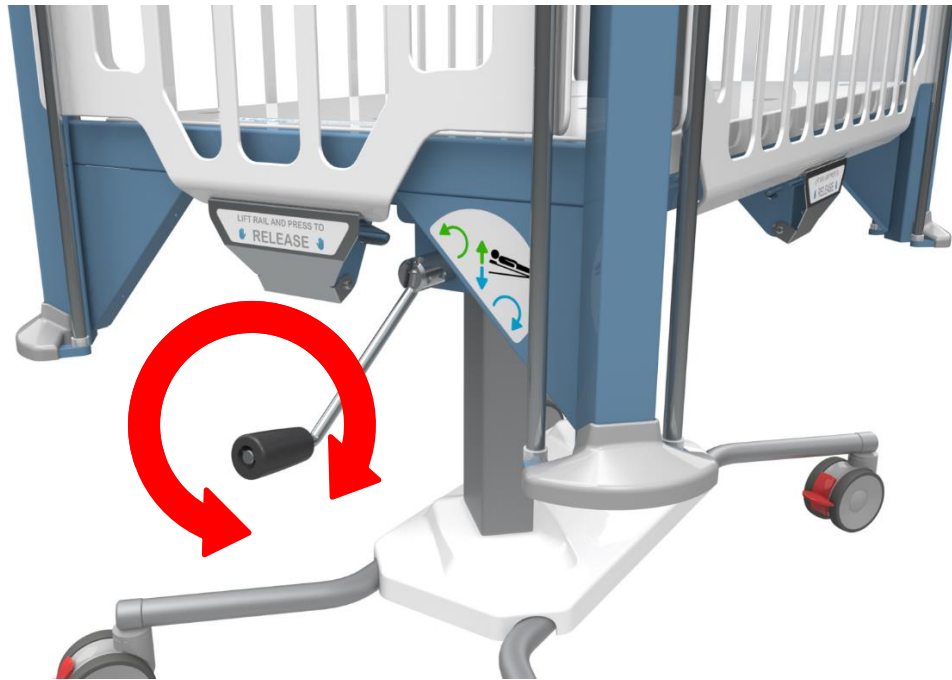

To **raise** the Trendelenburg angle wind anti-clockwise.

To **lower** the Trendelenburg angle wind clockwise.



SPECIFICATIONS

Basic Dimensions

| | |
|--|--------|
| OVERALL HEIGHT | 1560mm |
| OVERALL WIDTH | 875mm |
| OVERALL LENGTH | 1430mm |
| MATTRESS HEIGHT FROM FLOOR | 815mm |
| RAIL HEIGHT ABOVE MATTRESS BASE | 750mm |
| TRENDELENBURG ANGLE | +12° |

Mattress Size

| | |
|------------------|---------------|
| Thickness | 50mm to 100mm |
| Length | 1215mm |
| Width | 700mm |

Safe Working Load

| | |
|---------------|-------------|
| S.W.L. | 40Kg |
|---------------|-------------|

CLEANING

NOTE: It is strongly recommended that protective clothing be used when cleaning.

NOTE: The following procedure also applies to the cot accessories but does not include mattresses.

- Wipe the cot surfaces with a soft cloth moistened with hot water and mild detergent (or the facilities recommended cleaning solution) It is recommended that the cloth be white to prevent bleeding of die colours to the bed. Take extra care in area that can harbor dirt and dust.
- Rinse with clean water and dry with a clean cloth.
- Allow all cleaned parts to dry before replacing the mattress

! CAUTION !

- DO NOT use abrasive Hypocarbonate or Phenolic compounds or pads
- DO NOT use acids, alkaline, or any other chemical solvents
- DO NOT use agents which could alter the structure and behaviour of the power coat or any plastics. eg. petrol, toluene, acetone etc.

MAINTENANCE

Daily

- Visually check the cot for any signs of damage.
- Check castors roll freely
- Check safety latch operates freely

Weekly

- Check rails slide freely
- Check Trendelenburg winds freely up and down

Annually

- Check all fasteners and fixings

TRANSPORT & STORAGE

Handle with care.

The Alere cot should be stored in a cool dry well ventilated area.

Do not drop and avoid shock or violent impacts when transporting.

ACCESSORIES

A range of accessories are available for the Alere cot and are shown below.

- IV pole
- Oxygen bottle holder
- Central locking castors
- Riley access

WARRANTY & SERVICE

4Healthcare warrants that its products are free from defects in workmanship, materials and will repair / replace defective components from the purchase date of the manufacture of the products. 5 years for framework.

All service and repairs must be carried out by 4Healthcare or a certified 4Healthcare trained Technician. 4Healthcare will not be responsible for any expenses, inconvenience or incidental damages occasioned by the use, loss of use, or misuse of the products, or by failure of the products to conform to the warranty set forth above.

This warranty becomes void if the product shows evidence of mishandling, tampering, installation or use contrary to the application instruction material, shipping damage, or repair performed by other than a service personnel authorised by 4Healthcare.

Routine cleaning, adjustment and normal cosmetic and mechanical wear are not covered by this warranty. Prompt and written notice is required for a warranty claim.

No part of this publication may be reproduced without the prior written permission of 4Healthcare Pty Ltd.